

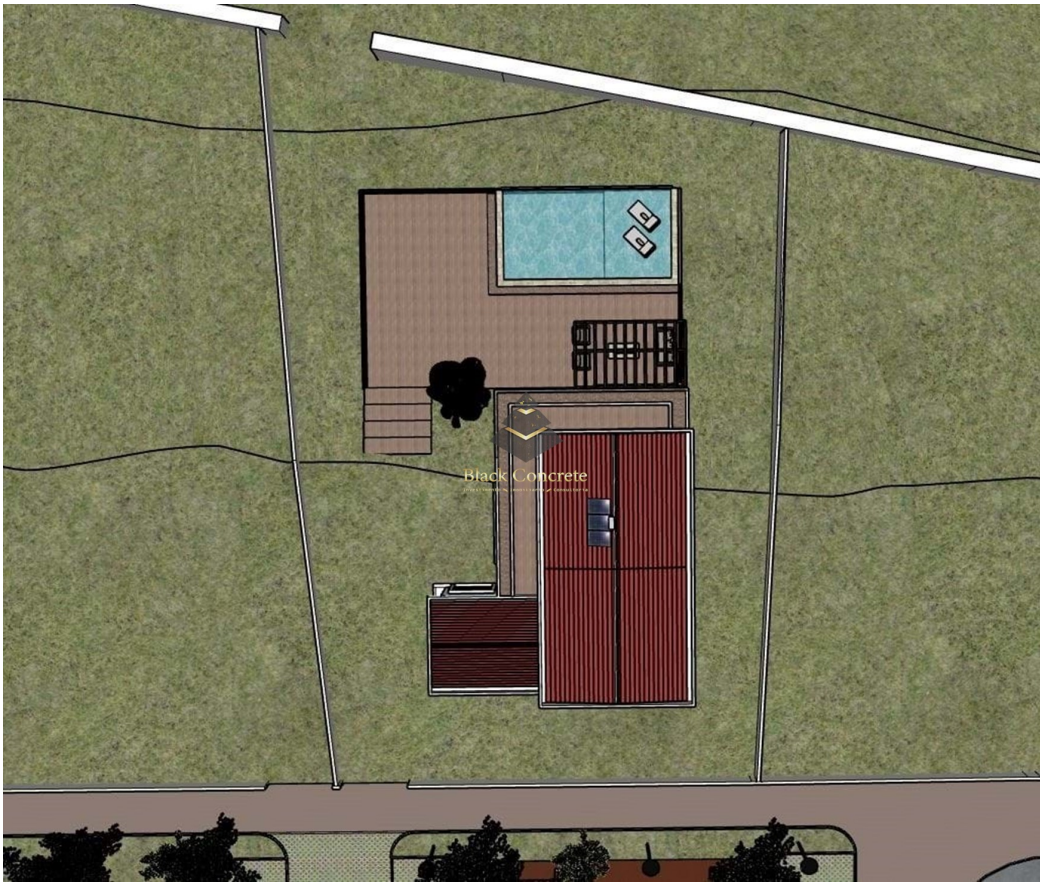

## Venda do Pinheiro e Santo Estêvão Das Galés - Land



 **1233,2**

Land Area (m<sup>2</sup>)

**200 000 €**

(EUR €)

### Urban Land In Mafra With Approved Project

Urban land in Lisbon has an approved housing project. It is located in Venda do Pinheiro - Mafra, close to supermarkets, restaurants, several farms and parks. The area is very quiet.

- a one-minute walk from the Middle School;
- a 9-minute drive from Aldi Supermarket;
- a 9-minute drive from Pingo Doce;
- a 10-minute drive from the Ecological Park;
- a 12-minute drive from LIDL Discount Supermarket;
- a 14-minute drive from the Malveira station;
- a 35-minute drive from Samara Beach.

The implementation area is 300 m<sup>2</sup>, the construction area - 450 m<sup>2</sup>.



**Seyed Azin Roshan**

Director

+351969954444 <sup>2</sup>

Azin@blackconcrete.pt

T +351 965 355 530 <sup>2</sup> · E info@blackconcrete.pt

Av da liberdade, N 110,1269-046, Lisbon

AMI 17190

<sup>1</sup> (Call to national fixed network) | <sup>2</sup> (Call to national mobile network)



BC386

Reference

Scan the QR code to view the property



It is an excellent opportunity for investment in your future home.  
Contact us to receive more information.

## Property Features

- Proximity: Beach, Shopping, Restaurants, City, Open field, Public Transport, Schools



**Seyed Azin Roshan**

Director

+351969954444 <sup>2</sup>

Azin@blackconcrete.pt

**T +351 965 355 530 <sup>2</sup> · E info@blackconcrete.pt**

**Av da liberdade, N 110,1269-046, Lisbon  
AMI 17190**

<sup>1</sup> (Call to national fixed network) | <sup>2</sup> (Call to national mobile network)